

## Adding Weather Effects to your Videos

In this tutorial, you'll learn how easy it is to add and customize weather effects like clouds, wind, lightning, rain and snow to your video projects. These weather elements are customizable in a variety of ways, depending on if you're looking for a natural or a supernatural effect.

### Adding Weather Effects

Open VideoStudio in the **Edit** tab and add your media to the **Video** track on the timeline. In this first example we will add a cloud and wind effect to the Flying a Kite image.

In the media library, click on the **FX** tab. Then select the **Special** category from the dropdown menu to view the various weather effects.

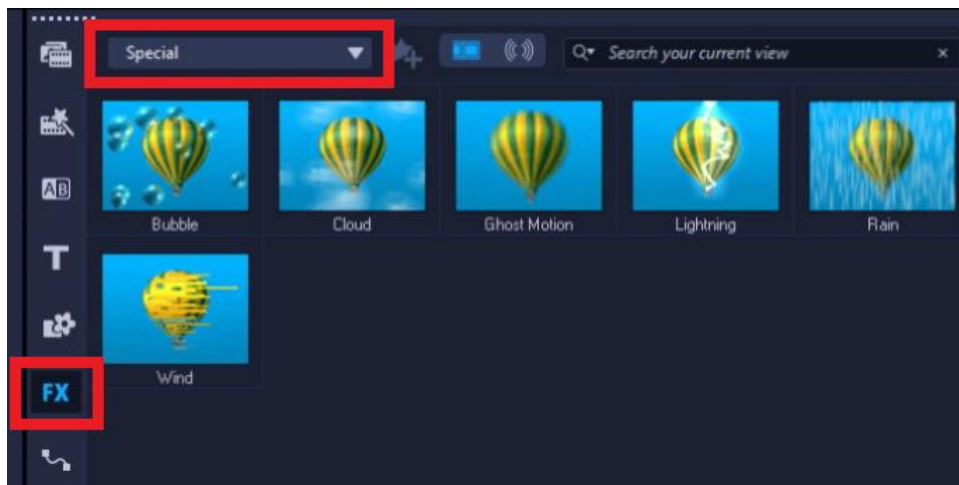

Select the **Wind** filter and drag it onto the flying kite clip in the timeline. The default wind effect will be added to your video.

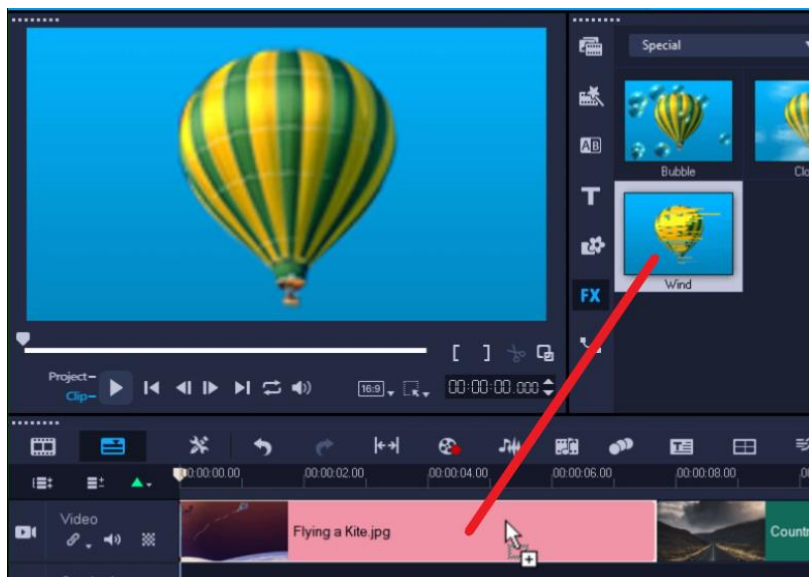

Double-click on the clip on the timeline to open the **Options** panel. On the **Effect** tab you can click on the dropdown arrow beside the thumbnail of the hot air balloon to preview various presets for the **Wind** filter.

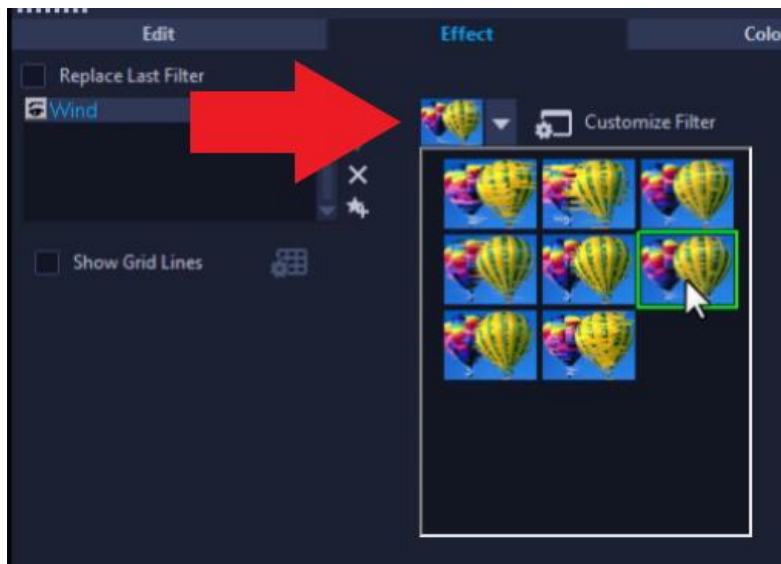

To add a second effect, click on the **Show Library Panel** icon in the bottom right corner of the **Options** panel to access the **FX** tab again.

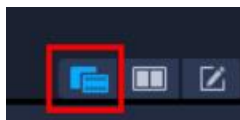

Select the **Cloud** filter and drag it onto your flying kite clip in the timeline. Once again, double-click on clip in the timeline to access the **Edit** tab in the **Options** panel.

To customize the size of the cloud effect, click on **Customize Filter**.

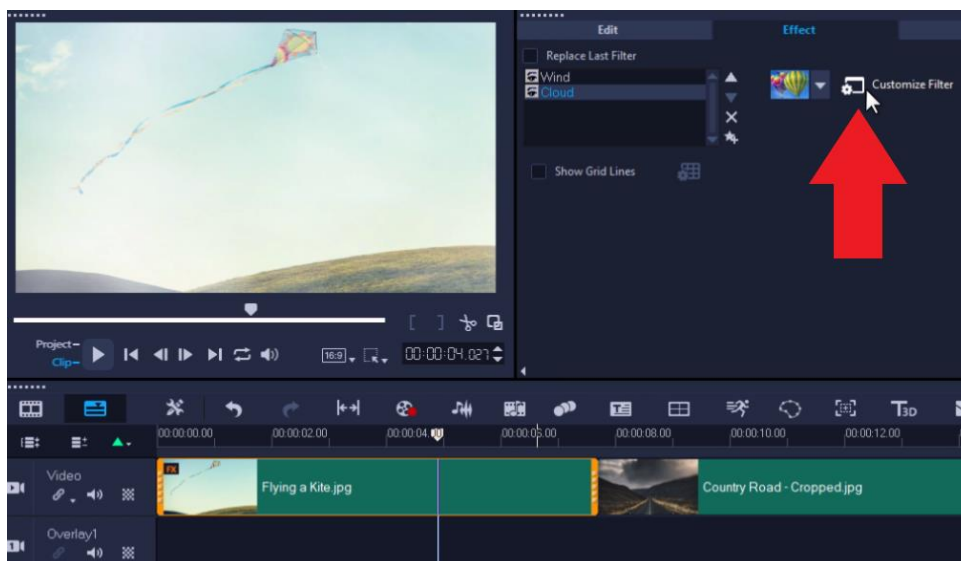

To make adjustments to the size of the clouds, select the first key frame.

Click on the **Advanced** tab and switch the **Motion type** to **Emitter**. From here, click on the small box on the preview pane and adjust where you want the starting position of the cloud effect.

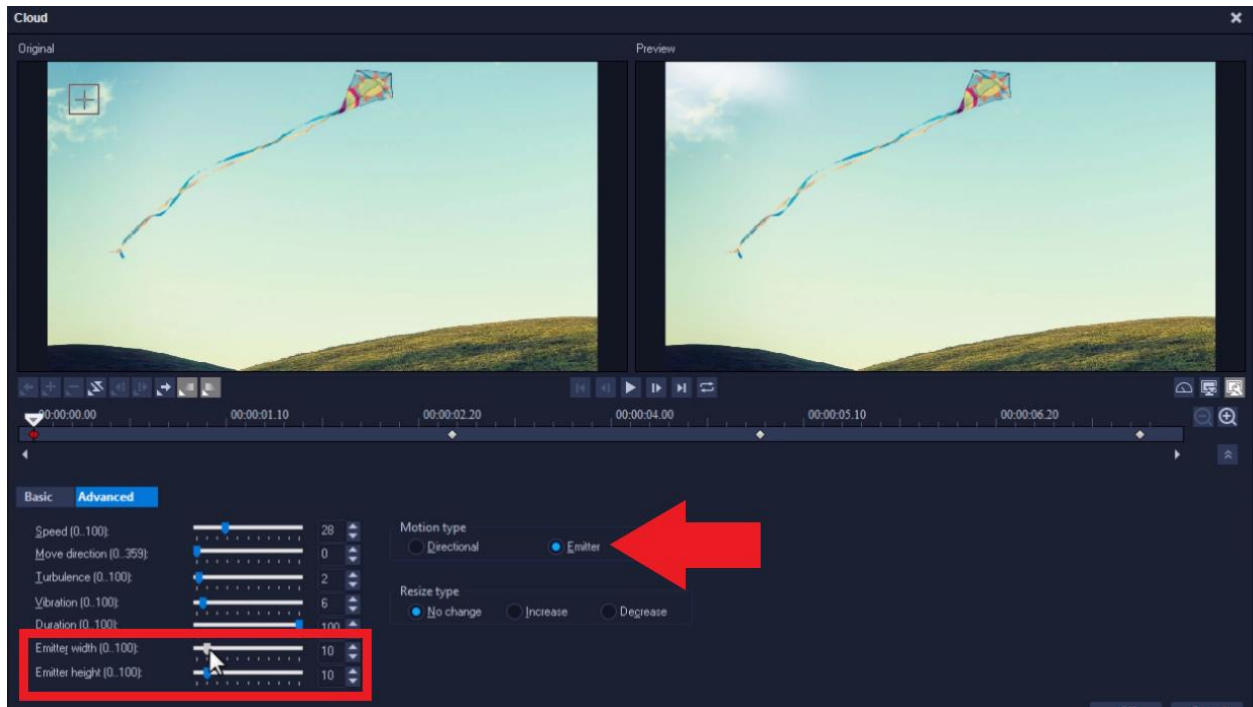

Then adjust the **Emitter Width** and **Emitter Height** sliders to get the starting size you would like.

Play around with these settings on the various key frames until you're happy with them and then click **OK**.

**NOTE:** When there is more than one video filter applied to a clip, you can change the order of filters by clicking the **Move filter up** or **down** arrows.

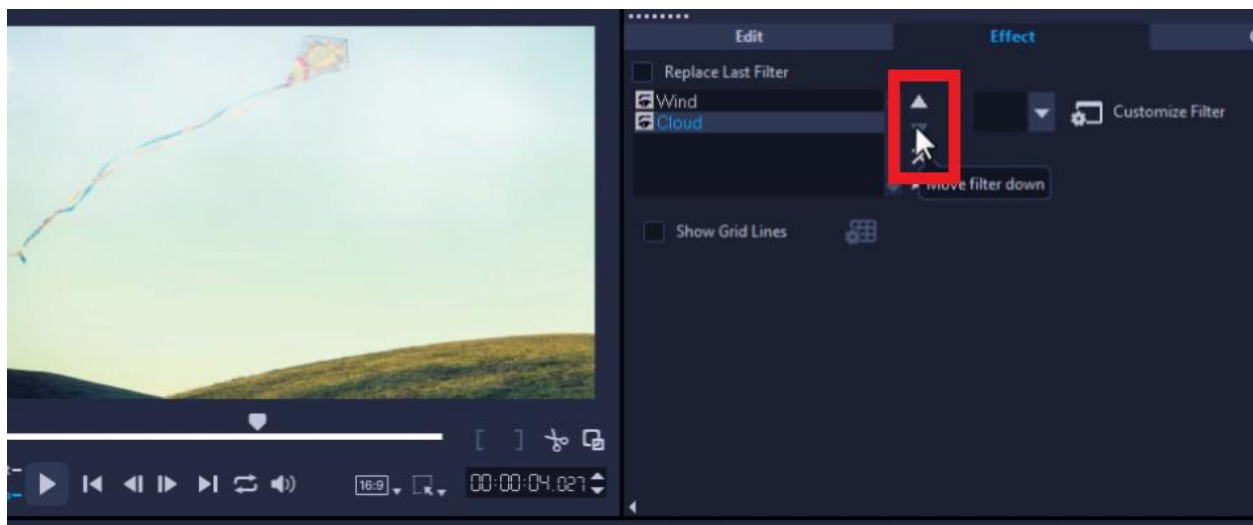

In this next example, we used the same process to add a rainstorm to the sample image Country Road, using the **Rain** and **Lightning** filters.



### Adding a Snow Effect

We can also alter the **Rain** filter to add a snow effect to the sample clip Deer in Winter. Add the clip to the timeline and then drag and drop the **Rain** filter onto. Double-click on the clip to open the Options panel as before, then click on the **Customize Filter** button. In this example we applied the following set of attributes to the starting keyframe:

- On the **Basic** tab, change the Density=1000, Length=1, Width=25, Background Blur=0, Variance=85, Body=0, and Opacity=75.

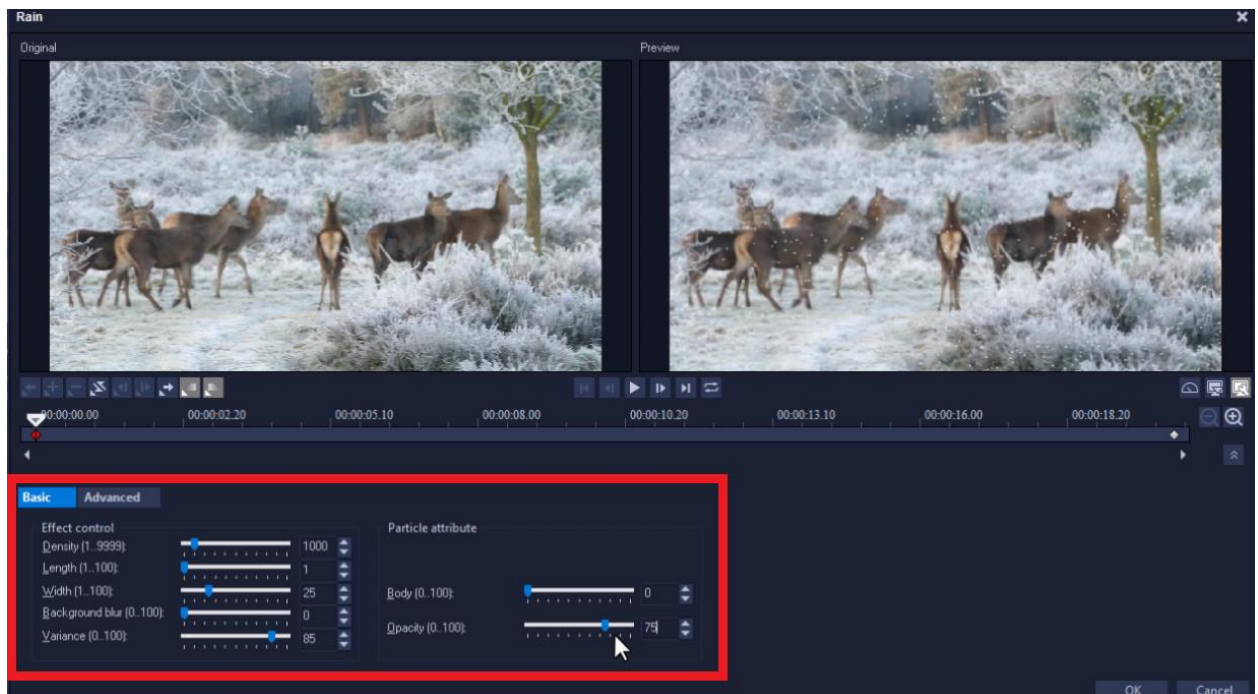



- On the **Advanced** tab, change the Speed=20, Wind Direction=270, Turbulence=20, and Vibration=20.



- Then, move to the ending keyframe and apply the same values that you applied to the starting keyframe.

You can experiment with different settings to adjust the density, speed or other parameters to create a gentle, light snowfall or a heavy, swirling snowstorm. Click **OK** when done to go back to the timeline editor.



Now press play to preview your video and you'll see a nice snowy effect has been added to your media clip!